

EDITION / VERSİYON
06/2010

WINDOW AND DOOR
PENCERE VE KAPI

SYSTEM 59T
SİSTEM 59T

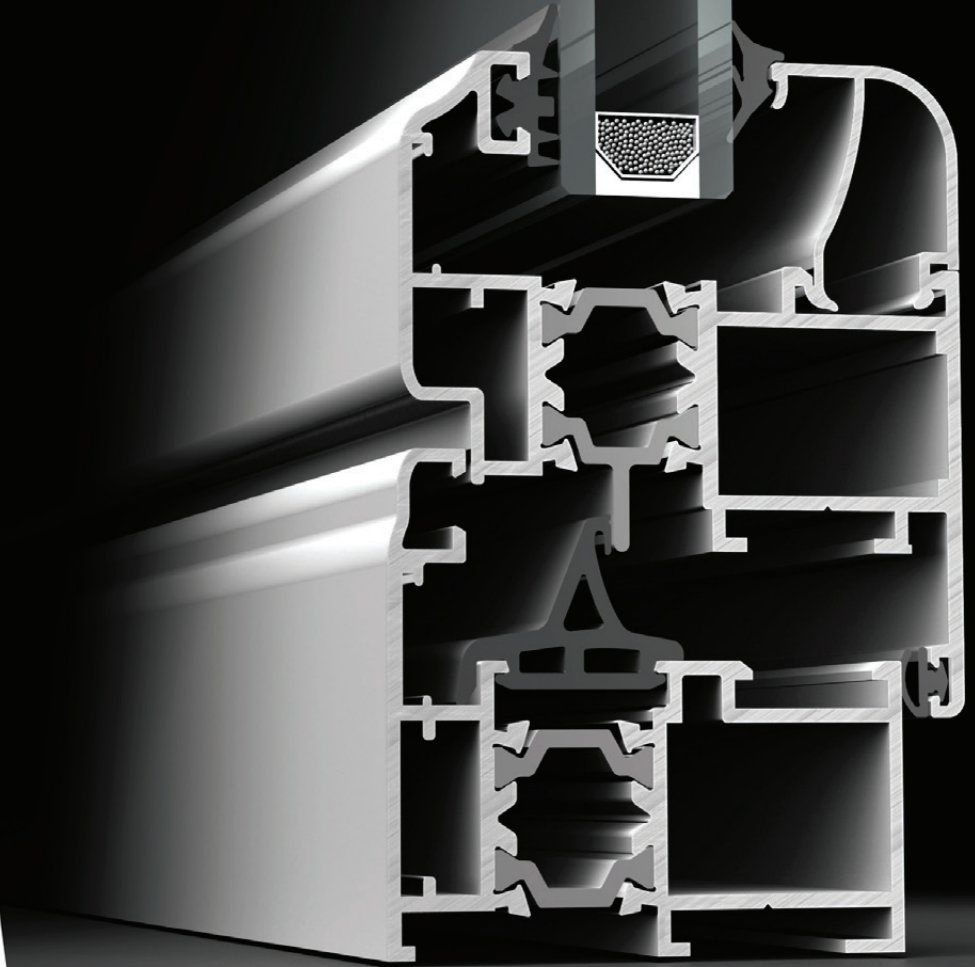

 **Lorenzoline**[®]
aluminium profile system



WINDOW AND DOOR PENCERE VE KAPI

SYSTEM 59T SİSTEM 59T

TECHNICAL INFORMATIONS / TEKNİK AÇIKLAMALAR

Window & Door Opportunities

Pencere ve Kapı Seçenekleri

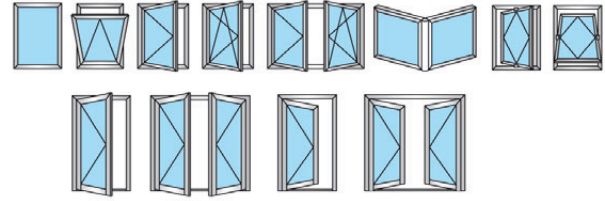

System Properties / Sistem Özellikleri

Modern Design / Modern Dizayn

Wall Thickness / Et Kalınlığı : 1.5 - 1.7 mm

Frame Height / Kasa Geniřliđi : 59 mm

Vent Height / Kanat Geniřliđi : 65 mm

Isolation Bar / Isı Bariyeri : 18 mm

Safety Drainage System / Güvenli Tahliye Sistemi

EPDM Gaskets / EPDM Fitol

Glazing From 4 mm to 28 mm

Cam Kullanımı 4mm' den 22 mm

Multilock Section / EPDM Fitol

Thermal Permability / EPDM Fitol : (Uf): 3.39 W/m2K

59T ALUminium / 59T ALÜminyum

Euro Groove 1 / Standart Avrupa Kanal 1

59T PERImetric / 59T PERİmetrik

- * Perimetric Groove suitable for 9 axis and 20 mm hinge mounting dimension / Perimetric 9 aks 20mm menteşe montaj mesafesine uygundur.
- * 09-154-00 extruded joint is suitable for GU unijet - D and Aubi A300 / 09-156-00 köşe takozu GU unijet - D ve Aubi A300 ile uyumludur.

Code Logic / Kod Mantığı

59T	101	00
Factory Standard Fabrika Standardı		
Group / Grup		
Title / Seri		

Titles / Seriler

59T - System Name / Sistem Adı

07 - Alternative Adaptors / Alternatif Adaptörler

08 - Glazing Beats / Cam Çıtalari

09 - Extruded Corner Joints / Pres Köşe Takozu

Groups / Gruplar

101, 102,... - Frames / Kasalar

201, 251,... - Vents / Kanatlar

301, 302,... - Mullions / Orta Kayıtlar

401, 402,... - Kick Plates and Adaptors / Etek ve Adaptörleri

501, 502,... - Adaptors / Adaptörler

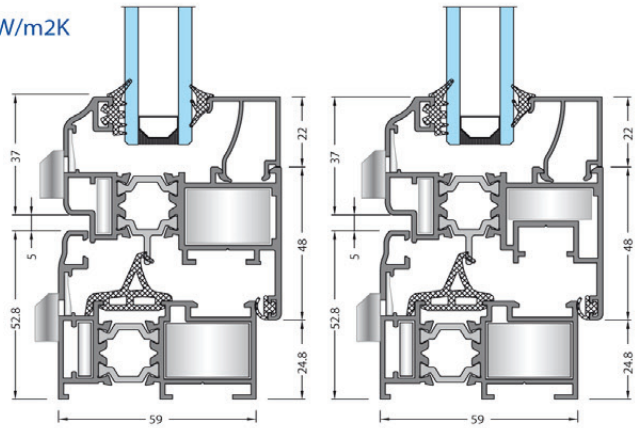

Euro Groove Section 1

Standart Avrupa Kanal 1

Perimetric Section

PVC Kanal

Alloy / Alařım

The alloys of the aluminium profiles are 6060 and 6063 (AlMgSi 0,5 - F22) based on EN 12020-2 / 755-9 standarts

Alüminyum profil alařımları 6060 ve 6063 (AlMgSi 0,5 - F22) EN 12020-2 / 755-9 standartlarına uygundur.

All drawings are not scaled.
Tüm çizimler ölçeşsizdir.

Lorenzoline
aluminium profile system



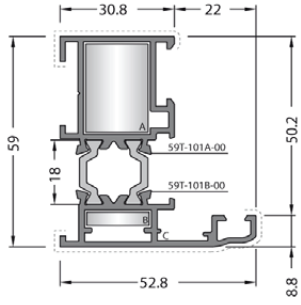

CODE / KOD
59T-101-00
THEORETICAL WEIGHT kg/m
TEORİK AĞIRLIK kg/m
1.311

EXTRUDED CORNER JOINT
KÖŞE TAKOZU



DIE-CAST CORNER JOINT
DÖKÜM BAĞLANTI

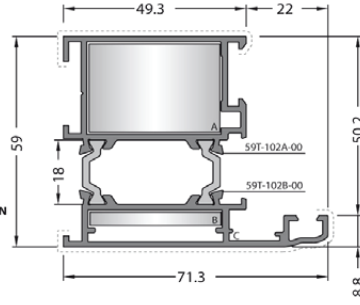

CODE / KOD
59T-102-00
THEORETICAL WEIGHT kg/m
TEORİK AĞIRLIK kg/m
1.627

EXTRUDED CORNER JOINT
KÖŞE TAKOZU

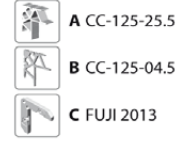

DIE-CAST CORNER JOINT
DÖKÜM BAĞLANTI

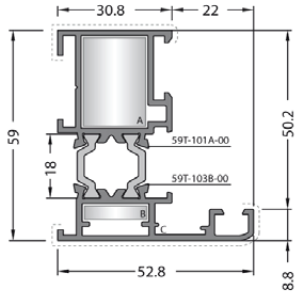

CODE / KOD
59T-103-00
THEORETICAL WEIGHT kg/m
TEORİK AĞIRLIK kg/m
1.315

EXTRUDED CORNER JOINT
KÖŞE TAKOZU



DIE-CAST CORNER JOINT
DÖKÜM BAĞLANTI

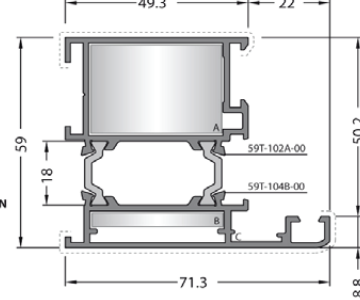

CODE / KOD
59T-104-00
THEORETICAL WEIGHT kg/m
TEORİK AĞIRLIK kg/m
1.631

EXTRUDED CORNER JOINT
KÖŞE TAKOZU



DIE-CAST CORNER JOINT
DÖKÜM BAĞLANTI

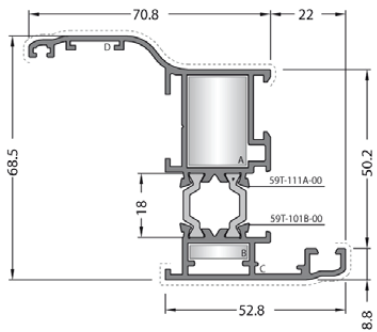

CODE / KOD
59T-111-00
THEORETICAL WEIGHT kg/m
TEORİK AĞIRLIK kg/m
1.550

EXTRUDED CORNER JOINT
KÖŞE TAKOZU

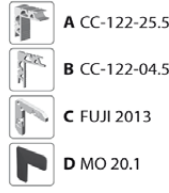

DIE-CAST CORNER JOINT
DÖKÜM BAĞLANTI

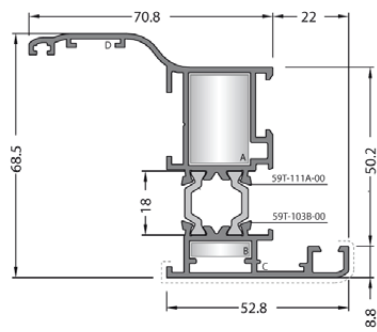

CODE / KOD
59T-113-00
THEORETICAL WEIGHT kg/m
TEORİK AĞIRLIK kg/m
1.554

EXTRUDED CORNER JOINT
KÖŞE TAKOZU

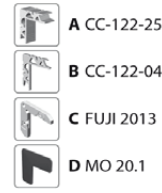

DIE-CAST CORNER JOINT
DÖKÜM BAĞLANTI

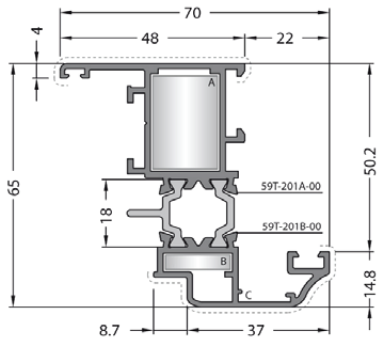

CODE / KOD
59T-201-00
THEORETICAL WEIGHT kg/m
TEORİK AĞIRLIK kg/m
1.484

EXTRUDED CORNER JOINT
KÖŞE TAKOZU



DIE-CAST CORNER JOINT
DÖKÜM BAĞLANTI

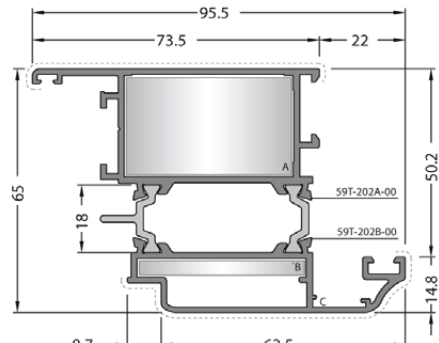

CODE / KOD
59T-202-00
THEORETICAL WEIGHT kg/m
TEORİK AĞIRLIK kg/m
1.901

EXTRUDED CORNER JOINT
KÖŞE TAKOZU

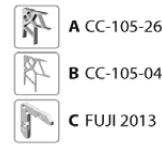

DIE-CAST CORNER JOINT
DÖKÜM BAĞLANTI

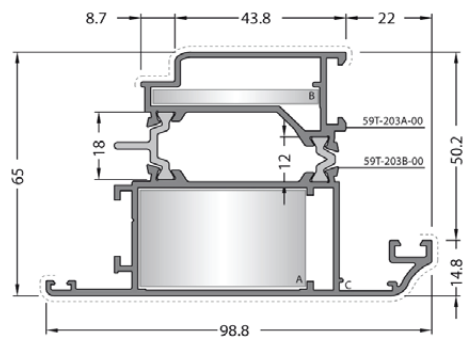

CODE / KOD
59T-203-00
THEORETICAL WEIGHT kg/m
TEORİK AĞIRLIK kg/m
1.982

EXTRUDED CORNER JOINT
KÖŞE TAKOZU

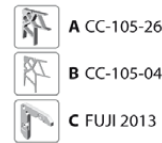

DIE-CAST CORNER JOINT
DÖKÜM BAĞLANTI



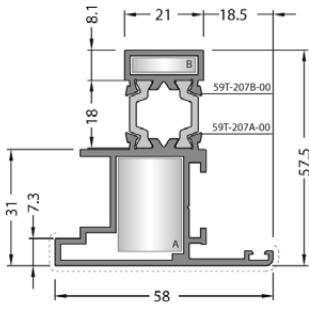

CODE / KOD
59T-207-00
THEORETICAL WEIGHT kg/m
TEORİK AĞIRLIK kg/m
1.294

EXTRUDED CORNER JOINT
KÖŞE TAKOZU

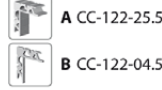

DIE-CAST CORNER JOINT
DÖKÜM BAĞLANTI



ANGULAR DIE-CAST CONNECTION
AÇILI PİMLİ BAĞLANTI

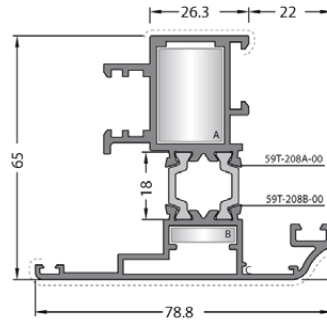

CODE / KOD
59T-208-00
THEORETICAL WEIGHT kg/m
TEORİK AĞIRLIK kg/m
1.690

EXTRUDED CORNER JOINT
KÖŞE TAKOZU



DIE-CAST CORNER JOINT
DÖKÜM BAĞLANTI



ANGULAR DIE-CAST CONNECTION
AÇILI PİMLİ BAĞLANTI

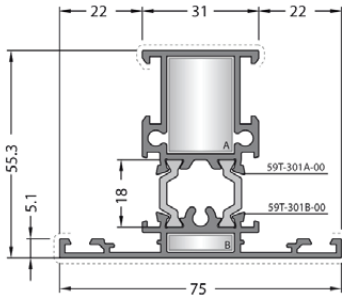

CODE / KOD
59T-301-00
THEORETICAL WEIGHT kg/m
TEORİK AĞIRLIK kg/m
1.488

EXTRUDED CORNER JOINT
KÖŞE TAKOZU



DIE-CAST CORNER JOINT
DÖKÜM BAĞLANTI



ANGULAR DIE-CAST CONNECTION
AÇILI PİMLİ BAĞLANTI



ANGULAR DIE-CAST CONNECTION
AÇILI PİMLİ BAĞLANTI

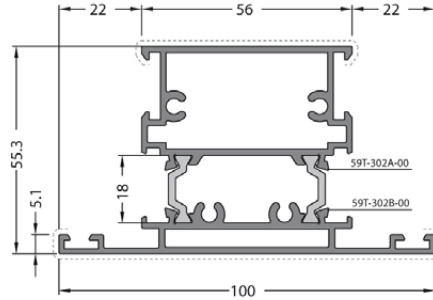

CODE / KOD
59T-302-00
THEORETICAL WEIGHT kg/m
TEORİK AĞIRLIK kg/m
2.106

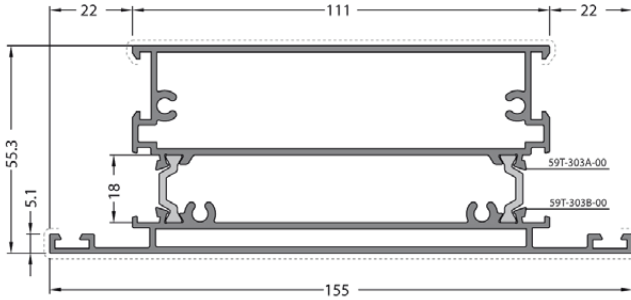

CODE / KOD
59T-303-00
THEORETICAL WEIGHT kg/m
TEORİK AĞIRLIK kg/m
3.120

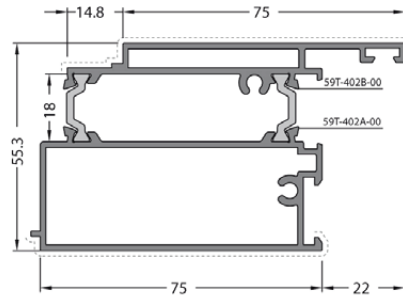

CODE / KOD
59T-402-00
THEORETICAL WEIGHT kg/m
TEORİK AĞIRLIK kg/m
1.984

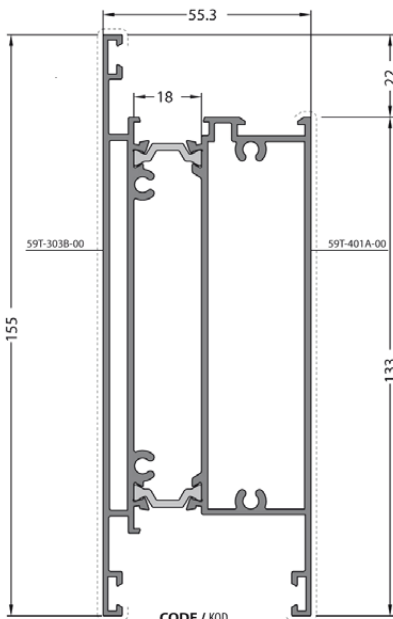

CODE / KOD
59T-401-00
THEORETICAL WEIGHT kg/m
TEORİK AĞIRLIK kg/m
3.183

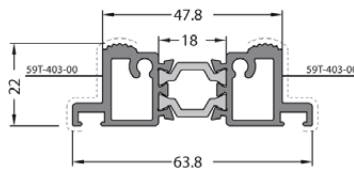

CODE / KOD
59T-403-00
THEORETICAL WEIGHT kg/m
TEORİK AĞIRLIK kg/m
1.112

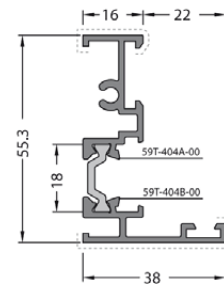

CODE / KOD
59T-404-00
THEORETICAL WEIGHT kg/m
TEORİK AĞIRLIK kg/m
0.796

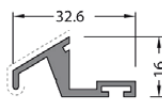

CODE / KOD
59T-405-00
THEORETICAL WEIGHT kg/m
TEORİK AĞIRLIK kg/m
0.331



CODE / KOD
59T-406-00
THEORETICAL WEIGHT kg/m
TEORİK AĞIRLIK kg/m
0.382

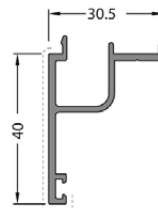

CODE / KOD
59T-407-00
THEORETICAL WEIGHT kg/m
TEORİK AĞIRLIK kg/m
0.446

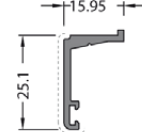

CODE / KOD
59T-408-00
THEORETICAL WEIGHT kg/m
TEORİK AĞIRLIK kg/m
0.225

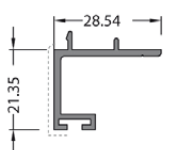

CODE / KOD
59T-409-00
THEORETICAL WEIGHT kg/m
TEORİK AĞIRLIK kg/m
0.312

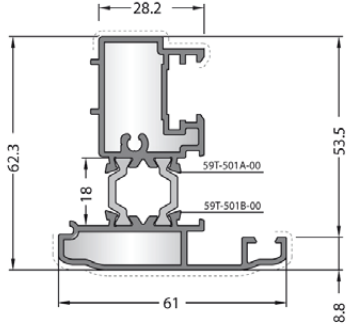

CODE / KOD
S9T-501-00
THEORETICAL WEIGHT kg/m
TEORİK AĞIRLIK kg/m
1.423
ADAPTOR CAP
ADAPTÖR KAPAKI
 EM59T-501

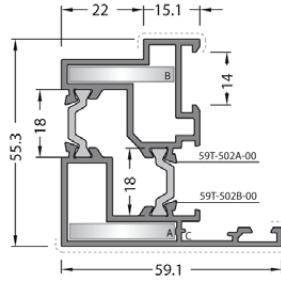

CODE / KOD
S9T-502-00
THEORETICAL WEIGHT kg/m
TEORİK AĞIRLIK kg/m
1.458
EXTRUDED CORNER JOINT
KÖŞE TAKOZU
 A CC-122-25.5
 B CC-122-04.5
 C FUJI 2013

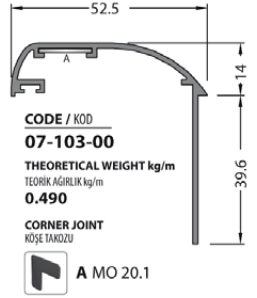

CODE / KOD
07-103-00
THEORETICAL WEIGHT kg/m
TEORİK AĞIRLIK kg/m
0.490
CORNER JOINT
KÖŞE TAKOZU
 A MO 20.1

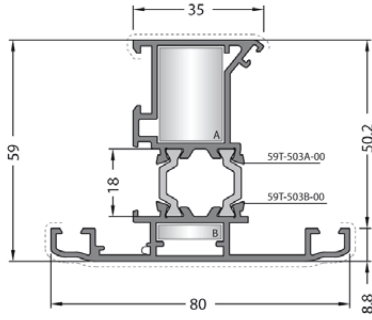

CODE / KOD
S9T-503-00
THEORETICAL WEIGHT kg/m
TEORİK AĞIRLIK kg/m
1.518
EXTRUDED CORNER JOINT
KÖŞE TAKOZU
 A CC-122-25.5
 B CC-122-04.5
 C FUJI 2013

DIE-CAST CORNER JOINT
DÖKÜM BAĞLANTI
 A LC-1826
ANGULAR DIE-CAST CONNECTION
AÇILI PİMLİ BAĞLANTI
 A LC-1828

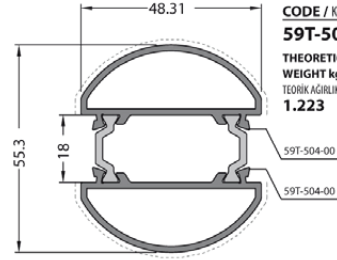

CODE / KOD
S9T-504-00
THEORETICAL WEIGHT kg/m
TEORİK AĞIRLIK kg/m
1.223

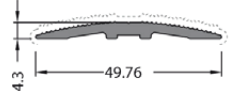

CODE / KOD
20-101-00
THEORETICAL WEIGHT kg/m
TEORİK AĞIRLIK kg/m
0.355

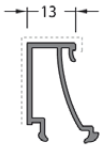

CODE / KOD
08-104-00
THEORETICAL WEIGHT kg/m
TEORİK AĞIRLIK kg/m
0.256

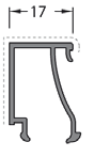

CODE / KOD
08-107-00
THEORETICAL WEIGHT kg/m
TEORİK AĞIRLIK kg/m
0.262



CODE / KOD
08-108-00
THEORETICAL WEIGHT kg/m
TEORİK AĞIRLIK kg/m
0.269

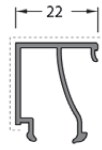

CODE / KOD
08-109-00
THEORETICAL WEIGHT kg/m
TEORİK AĞIRLIK kg/m
0.280

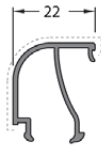

CODE / KOD
08-110-00
THEORETICAL WEIGHT kg/m
TEORİK AĞIRLIK kg/m
0.266

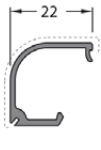

CODE / KOD
08-111-00
THEORETICAL WEIGHT kg/m
TEORİK AĞIRLIK kg/m
0.217

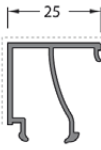

CODE / KOD
08-112-00
THEORETICAL WEIGHT kg/m
TEORİK AĞIRLIK kg/m
0.290

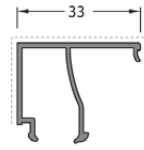

CODE / KOD
08-115-00
THEORETICAL WEIGHT kg/m
TEORİK AĞIRLIK kg/m
0.317

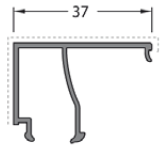

CODE / KOD
08-116-00
THEORETICAL WEIGHT kg/m
TEORİK AĞIRLIK kg/m
0.331

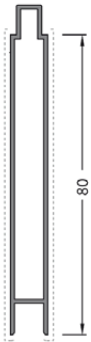

CODE / KOD
07-131-011
THEORETICAL WEIGHT kg/m
TEORİK AĞIRLIK kg/m
0.570



CODE / KOD
09-121-00
THEORETICAL WEIGHT kg/m
TEORİK AĞIRLIK kg/m
2.404
No visible surface
Görünen yüzeyi yoktur

EM1-04

EM1-02

EM1-04

EM1-02

CODE / KOD
09-122-00
THEORETICAL WEIGHT kg/m
TEORİK AĞIRLIK kg/m
3.306
No visible surface
Görünen yüzeyi yoktur

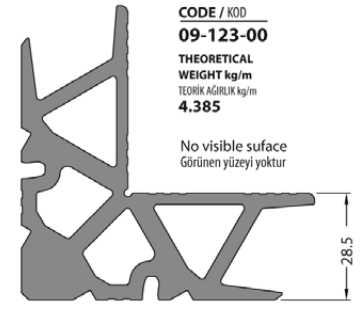

CODE / KOD
09-123-00
THEORETICAL WEIGHT kg/m
TEORİK AĞIRLIK kg/m
4.385
No visible surface
Görünen yüzeyi yoktur

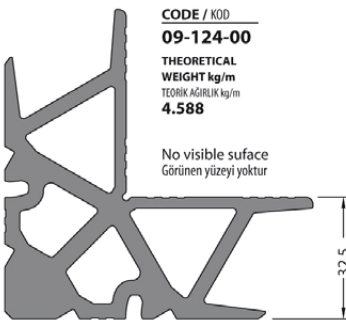

CODE / KOD
09-124-00
THEORETICAL WEIGHT kg/m
TEORİK AĞIRLIK kg/m
4.588
No visible surface
Görünen yüzeyi yoktur

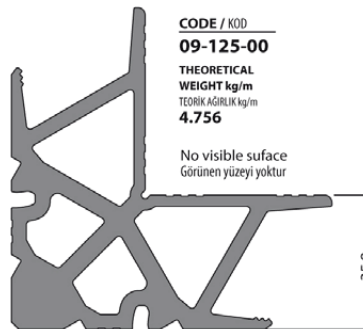

CODE / KOD
09-125-00
THEORETICAL WEIGHT kg/m
TEORİK AĞIRLIK kg/m
4.756
No visible surface
Görünen yüzeyi yoktur

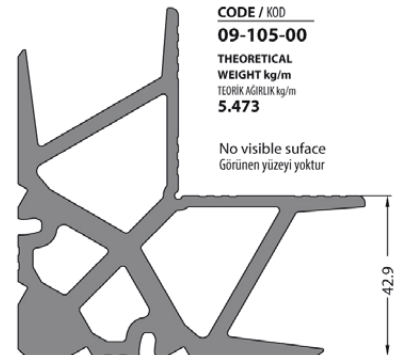

CODE / KOD
09-105-00
THEORETICAL WEIGHT kg/m
TEORİK AĞIRLIK kg/m
5.473
No visible surface
Görünen yüzeyi yoktur

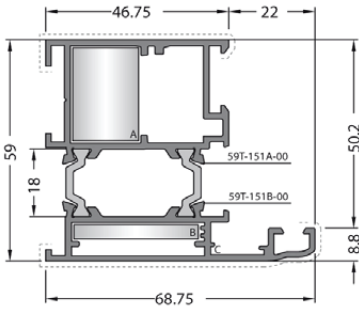

CODE / KOD

59T-151-00

THEORETICAL WEIGHT kg/m
TEORİK AĞIRLIK kg/m

1.625

EXTRUDED CORNER JOINT
KÖŞE TAKOZU



DIE-CAST CORNER JOINT
DÖKÜM BAĞLANTI



ANGULAR DIE-CAST CONNECTION
AÇILI PİMLİ BAĞLANTI

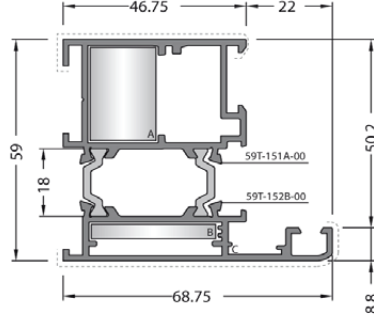

CODE / KOD

59T-152-00

THEORETICAL WEIGHT kg/m
TEORİK AĞIRLIK kg/m

1.629

EXTRUDED CORNER JOINT
KÖŞE TAKOZU

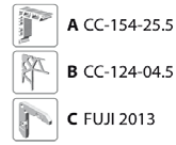

DIE-CAST CORNER JOINT
DÖKÜM BAĞLANTI



ANGULAR DIE-CAST CONNECTION
AÇILI PİMLİ BAĞLANTI

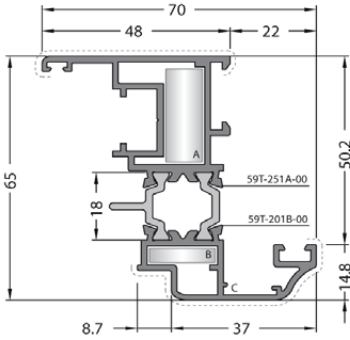

CODE / KOD

59T-251-00

THEORETICAL WEIGHT kg/m
TEORİK AĞIRLIK kg/m

1.533

EXTRUDED CORNER JOINT
KÖŞE TAKOZU

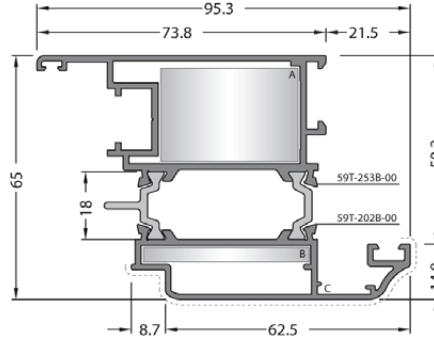

CODE / KOD

59T-253-00

THEORETICAL WEIGHT kg/m
TEORİK AĞIRLIK kg/m

1.961

EXTRUDED CORNER JOINT
KÖŞE TAKOZU

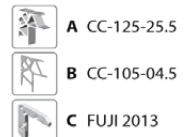

DIE-CAST CORNER JOINT
DÖKÜM BAĞLANTI

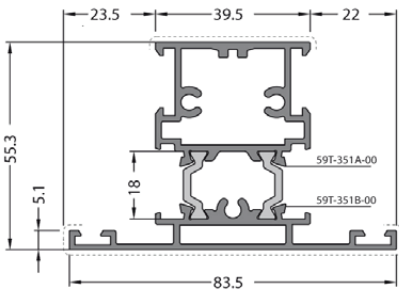

CODE / KOD

59T-351-00

THEORETICAL WEIGHT kg/m
TEORİK AĞIRLIK kg/m

1.780

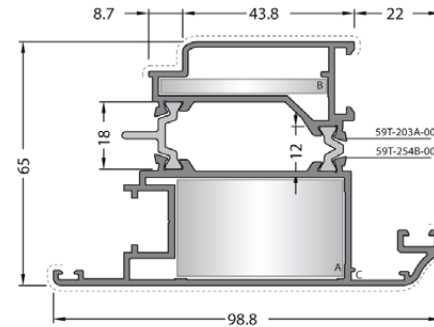

CODE / KOD

59T-254-00

THEORETICAL WEIGHT kg/m
TEORİK AĞIRLIK kg/m

2.031

EXTRUDED CORNER JOINT
KÖŞE TAKOZU

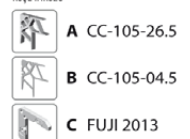

DIE-CAST CORNER JOINT
DÖKÜM BAĞLANTI

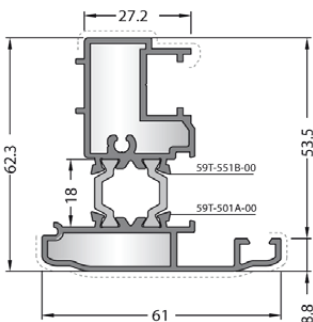

CODE / KOD

59T-551-00

THEORETICAL WEIGHT kg/m
TEORİK AĞIRLIK kg/m

1.423

ADAPTOR CAP
ADAPTOR KAPAKI

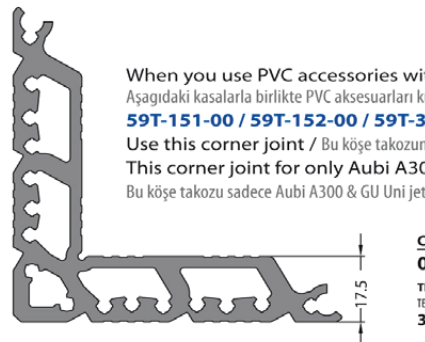

When you use PVC accessories with these Frames

Aşağıdaki kasalarla birlikte PVC aksesuarları kullanıldığında

59T-151-00 / 59T-152-00 / 59T-301-00

Use this corner joint / Bu köşe takozunu kullanınız.

This corner joint for only Aubi A300 & GU Uni jet D

Bu köşe takozu sadece Aubi A300 & GU Uni jet D ile uyumludur.

CODE / KOD

09-154-00

THEORETICAL WEIGHT kg/m
TEORİK AĞIRLIK kg/m

3.498

GASKETS / FİTİLLER

CODE KOD	DRAWING ÇİZİM	APLICATION UYGULAMA	DESCRIPTION AÇIKLAMA	WEIGHT kg/m AĞIRLIK kg/m	IN ONE PACKAGE PAKET MİKTARI
EM1-02			Glazing Gasket Inside (EPDM) İç Cam Fıtlı	0.050	300 m
EM1-03			Glazing Gasket Inside (EPDM) İç Cam Fıtlı	0.060	250 m
EM1-04			Glazing Gasket Inside (EPDM) İç Cam Fıtlı	0.070	215 m
EM2-02			Glazing Gasket Outside (EPDM) Dış Cam Fıtlı	0.080	185 m
EM3-01			Acoustical Gasket (EPDM) Bini Fıtlı	0.033	465 m
EM59-01			Central Gasket (EPDM) Tozduk Fıtlı	0.214	70 m
EM59-02			Fixed Frame Gasket (EPDM) Sabit Çerçeve Fıtlı	0.080	185 m

CODE KOD	DRAWING ÇİZİM	DESCRIPTION AÇIKLAMA	IN ONE PACKAGE PAKET MİKTARI
EM59-11		Corner Gasket (EPDM) Köşe Fıtlı	500

GLAZING COMBINATION / CAM KOMBİNASYONLARI

GLAZING THICKNESS ÇİZİM	GLAZING GASKET INSIDE İÇ CAM FİTLİ	GLAZING GASKET OUTSIDE DİŞ CAM FİTLİ	GLAZING BEAD CAM ÇİTASI
4 mm	EM1-04	EM2-02	08-116-00
5 mm	EM1-03	EM2-02	
6 mm	EM1-02	EM2-02	
8 mm	EM1-04	EM2-02	08-115-00
10 mm	EM1-02	EM2-02	
17 mm	EM1-03	EM2-02	08-112-00
20 mm	EM1-03	EM2-02	08-111-00
	EM1-03	EM2-02	08-110-00
	EM1-03	EM2-02	08-109-00
22 mm	EM1-04	EM2-02	08-108-00
24 mm	EM1-02	EM2-02	
24 mm	EM1-04	EM2-02	08-107-00
26 mm	EM1-02	EM2-02	
28 mm	EM1-04	EM2-02	08-104-00

ACCESSORY CODE AKSESUAR KOD	DRAWING ÇİZİM	APLICATION PROFILES ÇALIŞTIĞI PROFİL	APLICATION DETAIL UYGULAMA DETAYI
EM59T-501 ALUminium		59T-501-00	
EM59T-551 PERImetric		59T-551-00	
EM08-111		08-111-00	
EM15-200		Polyamid Rod Profile (Euro Section 1) Polyamid Tıj Profili (Araupa Kanal 1)	
EM10-01 (White / Beyaz)		Drainage Cap Tahliye Kapağı	
EM10-02 (Black / Siyah)			
EM10-03 (Brown / Kahverengi)			
EM10-04 (Gray / Gri)			
LC01-01		Lorenzoline Punching Machine Lorenzoline Patlatma Makinası	

CODE KOD	DRAWING ÇİZİM	APLICATION PROFILES UYGULAMA PROFİLİ	APLICATION DETAILS UYGULAMA DETAYI
LC-1826		59T-101-00	
		59T-103-00	
		59T-111-00	
		59T-113-00	
		59T-151-00	
LC-1828		59T-201-00	
		59T-207-00	
		59T-208-00	
		59T-301-00	
		59T-503-00	
LC-1827		59T-301-00	
LC-3626		59T-102-00	
		59T-104-00	
		59T-253-00	
LC-4327		59T-202-00	
		59T-203-00	
		59T-254-00	
FUJI 2013		59T-101-00	
		59T-102-00	
		59T-103-00	
		59T-104-00	
		59T-111-00	
		59T-113-00	
		59T-201-00	
		59T-202-00	
		59T-203-00	
		59T-208-00	
		59T-301-00	
		59T-502-00	
		59T-503-00	
		59T-151-00	
		59T-152-00	
MO 20.1		59T-111-00	
		59T-113-00	
		07-103-00	

PROFILE CODE PROFİL KODU	DRAWING ÇİZİM	PACKAGE CODE PAKET KODU	QUANTITY MİKTAR	CUTTING SIZE KESİM ÖLÇÜSÜ	APLICATION PROFILES ÇALIŞTIĞI PROFİL	APLICATION DETAIL UYGULAMA DETAYI
09-105-00		CC-105-04.5	33 pieces	04.5 mm	59T-202-00 59T-203-00 59T-253-00 59T-254-00	
09-105-00		CC-105-26.5	15 pieces	26.5 mm	59T-202-00 59T-203-00 59T-253-00	
09-121-00		CC-121-25.5	80 pieces	25.5 mm	59T-251-00	
09-122-00		CC-122-04.5	77 pieces	04.5 mm	59T-101-00	
					59T-103-00	
					59T-111-00	
					59T-113-00	
					59T-201-00	
					59T-207-00	
					59T-208-00	
09-122-00		CC-122-25.5	35 pieces	25.5 mm	59T-101-00	
					59T-103-00	
					59T-111-00	
					59T-113-00	
					59T-201-00	
					59T-207-00	
					59T-208-00	
09-123-00		CC-123-04.5	55 pieces	04.5 mm	59T-502-00	
09-124-00		CC-124-04.5	44 pieces	04.5 mm	59T-151-00	
					59T-152-00	
09-125-00		CC-125-04.5	44 pieces	04.5 mm	59T-102-00	
					59T-104-00	
09-125-00		CC-125-25.5	20 pieces	25.5 mm	59T-102-00	
					59T-104-00	
					59T-253-00	

SPECIAL EXTRUDED CORNER JOINT FOR PERIMETRIC

When you use PVC accessories with these Frames

Aşağıdaki kasalarla birlikte PVC aksesuarları kullanıldığında

59T-151-00 / 59T-152-00 / 59T-301-00

Use this corner joint.

Bu köşe takozunu kullanınız.

This corner joint for only Aubi A300 & GU Uni jet D

Bu köşe takozu sadece Aubi A300 & GU Uni jet D ile uyumludur.

PROFILE CODE PROFİL KODU	DRAWING ÇİZİM	PACKAGE CODE PAKET KODU	QUANTITY MİKTAR	CUTTING SIZE KESİM ÖLÇÜSÜ	APLICATION PROFILES ÇALIŞTIĞI PROFİL	APLICATION DETAIL UYGULAMA DETAYI
09-154-00		CC-154-25.5	35 pieces	25.5 mm	59T-151-00 59T-152-00 59T-301-00	

aluminium details

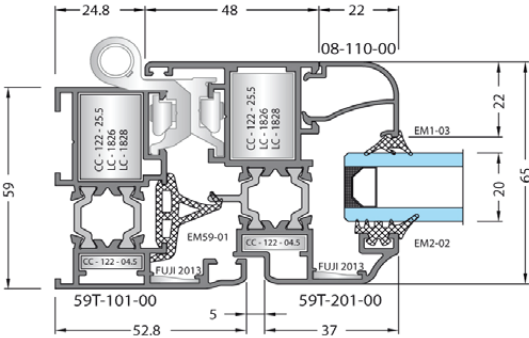

perimetric details

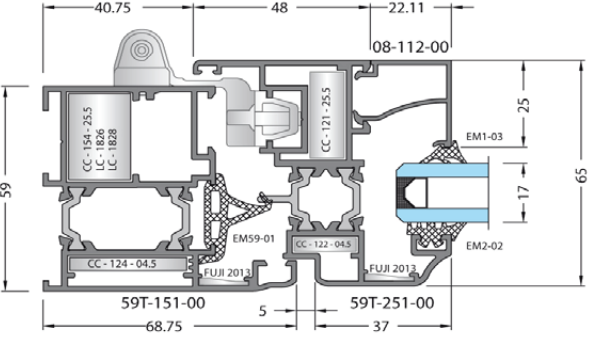

aluminium details

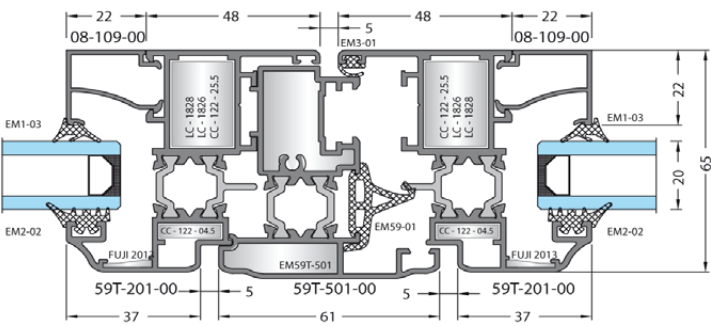

perimetric details

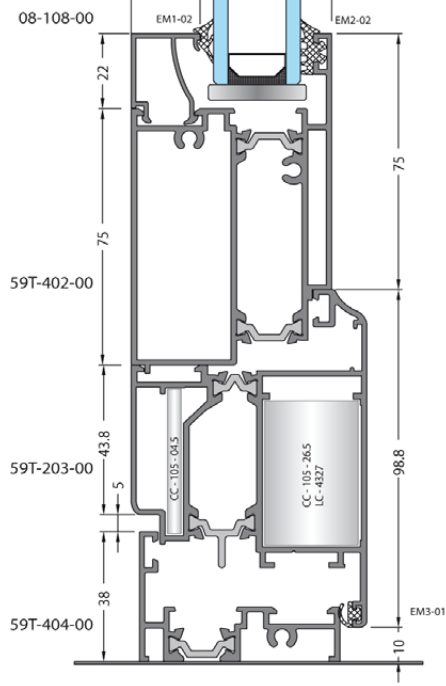
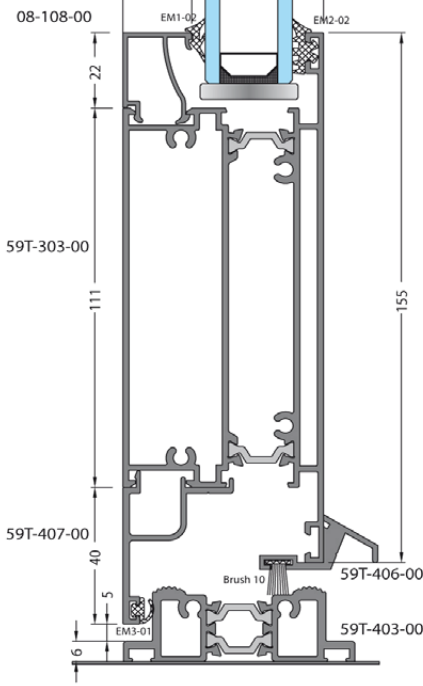
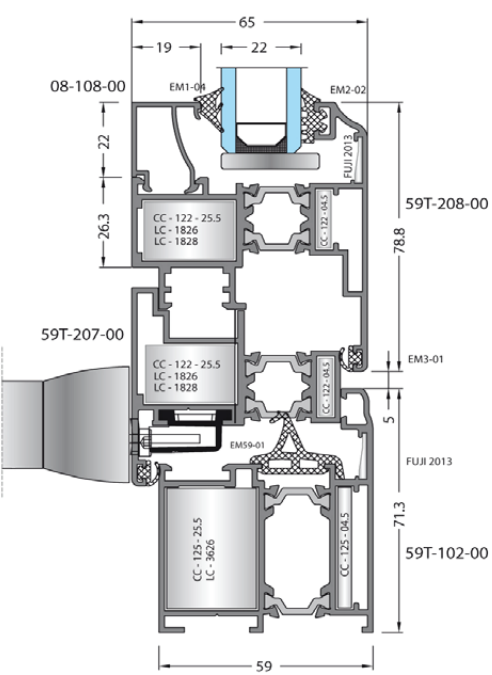
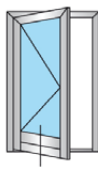
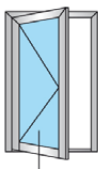
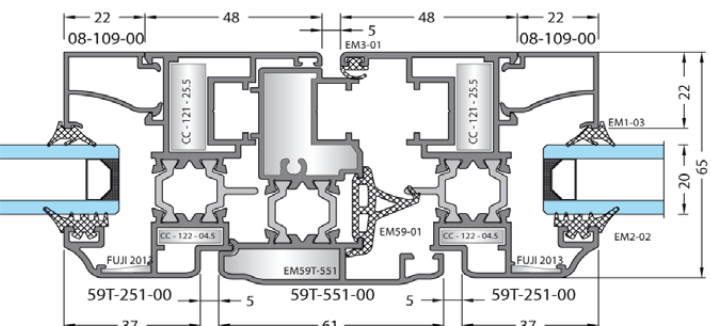



Produced by 

KURTOĞLU BAKIR - KURŞUN SAN. A.Ş.

Hacıseremet Mevkii, Tem Çorlu Çıkışı Velimeşe 59880 Pk 323 Tekirdağ / TÜRKİYE
T: +90 282 684 70 00 F: +90 282 684 70 01
www.kurtogluas.com kurtoglu@kurtogluas.com

 **Lorenzoline**[®]
aluminium profile system